



iS30-Ex

The iS30-Ex offers you more freedom in Ex zones. Flexible in use and location this compact weighing terminal also impresses in terms of ease of use. An example: Optimal view with the large full graphic display. The broad range of interfaces and software programs guarantees efficient production processes and a constantly high product quality. Safe, precise and reliable.



More information
High performance
with a wide range of
solutions and options.

Specifications	Facts	Details
Housing	Front: Plastic Housing: Stainless steel Wall / table mounting VESA 100 mounting option	Polyamide glass fiber reinforced 1.4301
Dimensions	W x H x T 300 x 230 x 99 mm 345 x 267 x 150 mm	Without table-top/wall mounting With table-top/wall mounting
Auxiliary power, integrated power supply	Mains supply 120 - 240 V 24 V AC / DC 24 V DC, rechargeable battery	50 / 60 Hz
IP rating	IP65	according to DIN 40050 (EN 60529)
Ambient temperature	-10 °C to +40 °C -20 °C to +60 °C	Operation metrologically approved Storage / transport:
Display	Size 5.7" Resolution 320 x 240 px Display field 115 x 86 mm	Full graphic TFT display with white LED back-lighting
Membrane keyboard with a total of 39 keys	<ul style="list-style-type: none"> – Six keys for basic weighing functions – Four function keys with two arrow keys – Four application keys – Numeric keypad for alphanumeric input – Navigation keys – Stand-by key – Switch key for scale 	<ul style="list-style-type: none"> – Info, zero setting, tare, delete tare, recording and manual tare – Functions can be freely assigned – Input of process data – With keys C, decimal point, shift key and Enter – With keys OK, ESC and quick access – Weighing terminal ON/OFF button – Switching between scale 1 and 2
Standard interfaces	ETHERNET WLAN	Increased safety For service purposes (adjust configuration)
Scale interface	Weighing module 1	Analog digital converter for strain gauge load cells
ES for verified application	Metrologically approved data storage Basic	Including SD card
Application programs	Basic software weighing	More software programs optionally available
ATEX identification	 Ex II 2G  Ex II 2D	Gas Dust
Normative labeling	Ex eb ib [ib] mb IIC T4 Gb Ex tb [ib] IIIC T80°C Db	Gas Dust

Options	Facts	Details
Optional interfaces	Scanner interface RS232 TTY Profibus-DP Analog output I/O (4/4) to I/O (16/16)	Max. 5 V, intrinsically safe Intrinsically safe Intrinsically safe Only power output, intrinsically safe Intrinsically safe
Second scale interface	Weighing module 2	Analog digital converter for strain gauge load cells
ES for verified application	Metrologically approved data storage Basic	Including SD card
Program licenses	Counting Tolerance control Statistics Dosing Recording database Data input devices Data output devices Field bus	SW program counting SW program tolerance control SW program statistics SW program single-component dosing/filling For EDP Connection volume measuring device, scanner, etc. Connection of printer, remote display, etc. Profibus-DP
Power cable	3 m Variable length Customer side	Parts kit
Rechargeable battery	Battery box BK-Ex 24 V, capacity 10 Ah	Stainless steel housing with handle IP65 protection Connection via flange connector Operating time approx. 10-30 hours, depending on configuration level
Charger	Charger for 24 V battery box	Power supply 220/240 V, 50 Hz 24 V with European standard size plug IP20 protection
Battery holder	Stainless steel version	
Measuring cable	Variable lengths	For connection of a load receptor
Data and control cables	Various data and control cables	3 m, 6 m, 10 m or running meter
Control panel installation	Installation variant in control panel Stainless steel 1.4301 IP65 protection	W x H x T 266 x 173 x 86.7 mm
Column	Stainless steel	1.4301
Protective hood	Transparent protective cover	For table / wall mounting only

Symbols



Ex zone

IP rating

WLAN

Dimensional drawings

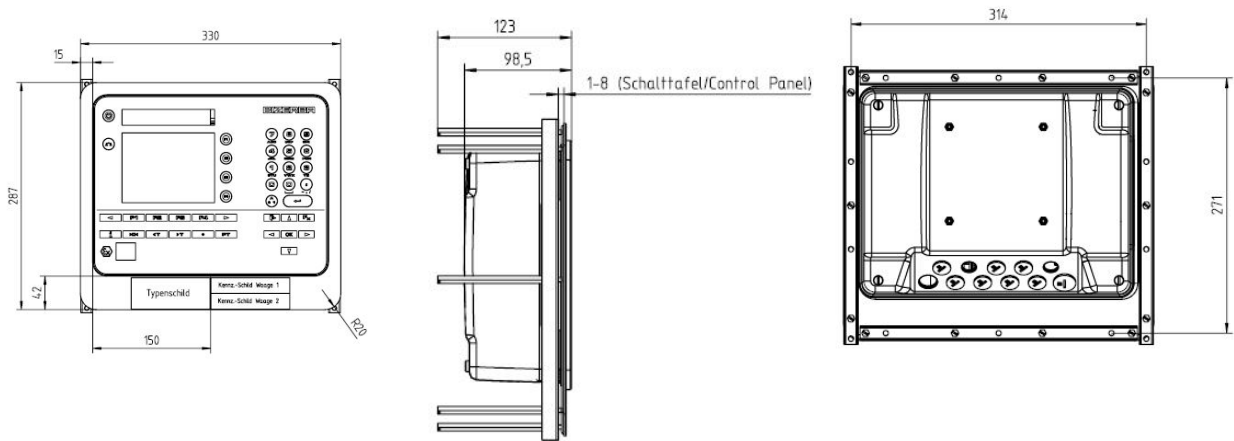

Bizerba SE & Co. KG
Wilhelm-Kraut-Straße 65
72336 Balingen

T +49 7433 12-0
fax: +49 7433 12-2696
marketing@bizerba.com

www.bizerba.com